

KOL  
LEKTI  
VETTER  
LIVES  
Bar & Scene

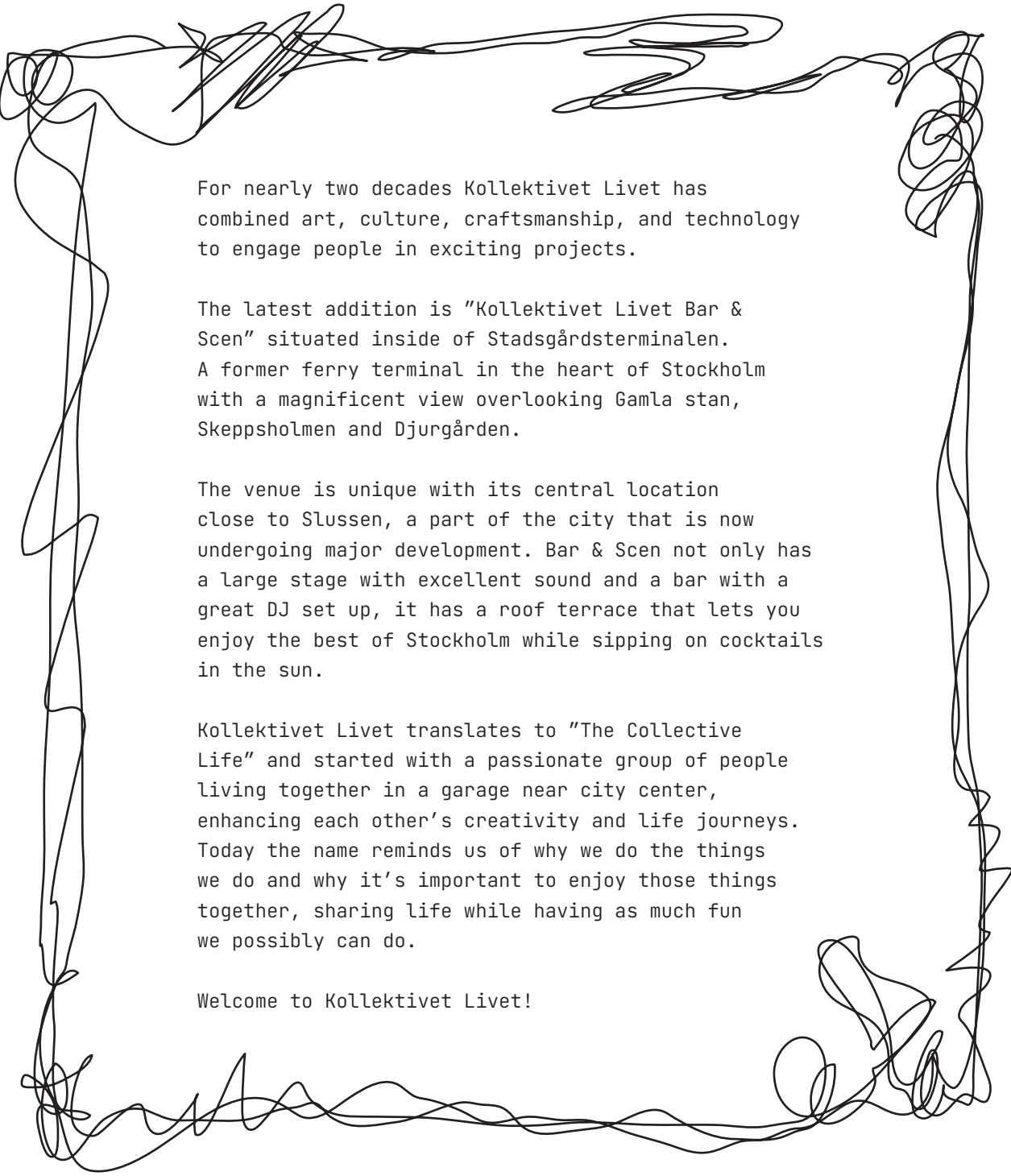

VENUE SPECIFICATION

# BACKSTORY



For nearly two decades Kollektivet Livet has combined art, culture, craftsmanship, and technology to engage people in exciting projects.

The latest addition is "Kollektivet Livet Bar & Scen" situated inside of Stadsgårdsterminalen. A former ferry terminal in the heart of Stockholm with a magnificent view overlooking Gamla stan, Skeppsholmen and Djurgården.

The venue is unique with its central location close to Slussen, a part of the city that is now undergoing major development. Bar & Scen not only has a large stage with excellent sound and a bar with a great DJ set up, it has a roof terrace that lets you enjoy the best of Stockholm while sipping on cocktails in the sun.

Kollektivet Livet translates to "The Collective Life" and started with a passionate group of people living together in a garage near city center, enhancing each other's creativity and life journeys. Today the name reminds us of why we do the things we do and why it's important to enjoy those things together, sharing life while having as much fun we possibly can do.

Welcome to Kollektivet Livet!



# VENUE INFO



**Venue Concerts & Club**

**Capacity** 550 pp + Roof terrace 150 pp

**Address** Stadsgårdsterminalen, 116 45 Stockholm

**Artist booking & Music program** [gustav@kollektivettlivet.se](mailto:gustav@kollektivettlivet.se)

**Private and commercial events** [info@kollektivettlivet.se](mailto:info@kollektivettlivet.se)

---

## **Facility**

- Dressing room
  - Toilets
  - Shower
  - Fridge
  - High bandwidth Wifi
- 

**Stage dimensions** See mainstage drawing for exact measurements

**Stage floor to ceiling** 3,4 meter

**Stage floor dimensions** Aprox 12 x 12 meter

---

## **Rigging**

Fixed Stage, Sound and light.

## **Load in access**

Street level, access with truck on the backside of the building (Godsmottagning).

## **Dead case storage**

Behind and under the stage.

---

**Get in, Get out** By appointment

**Parking** By appointment

**Catering** Yes, see separate document

# VENUE BAR & STAGE

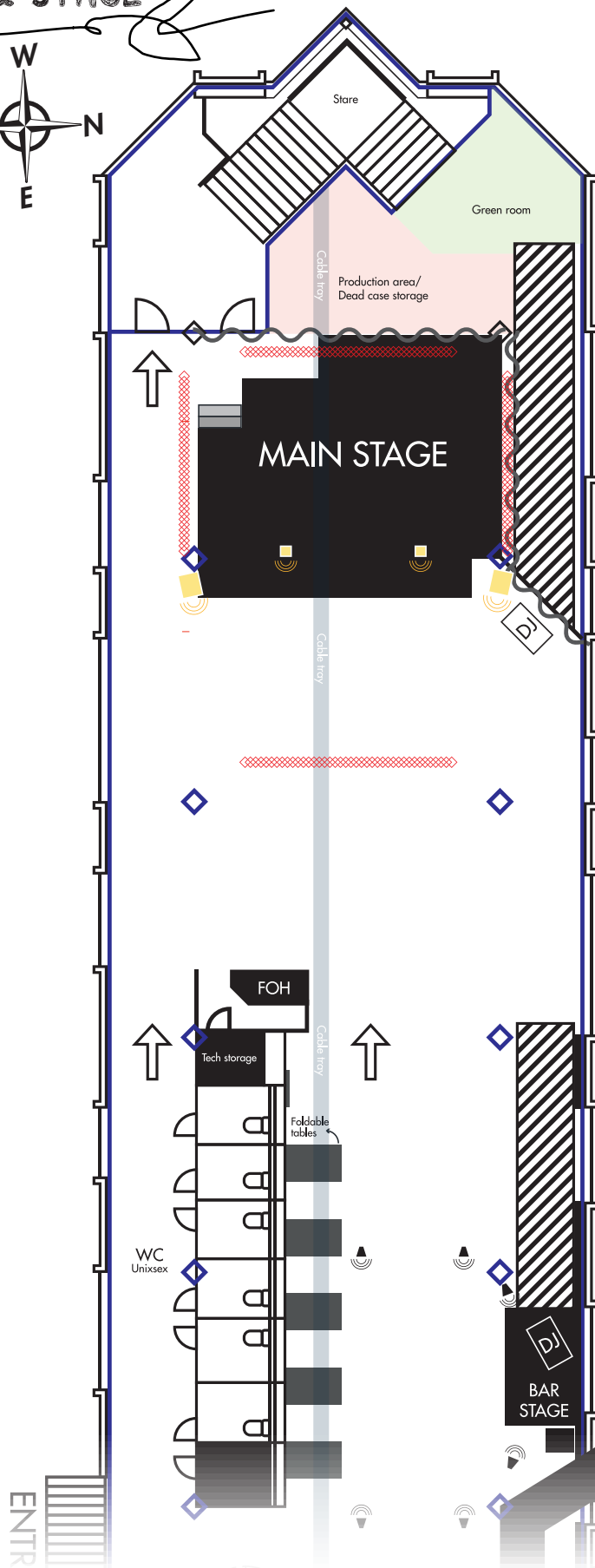
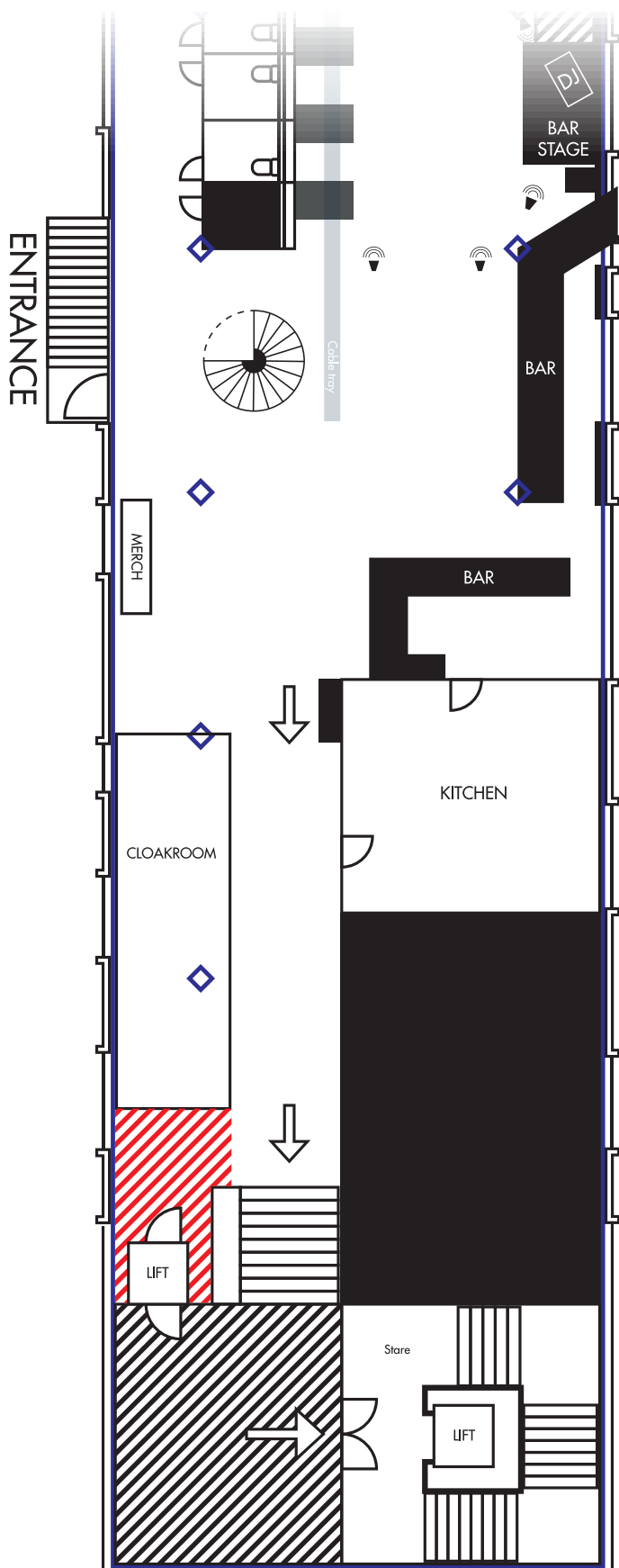
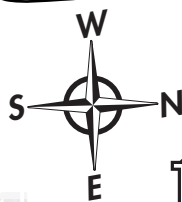

# MAIN STAGE DIMENSIONS

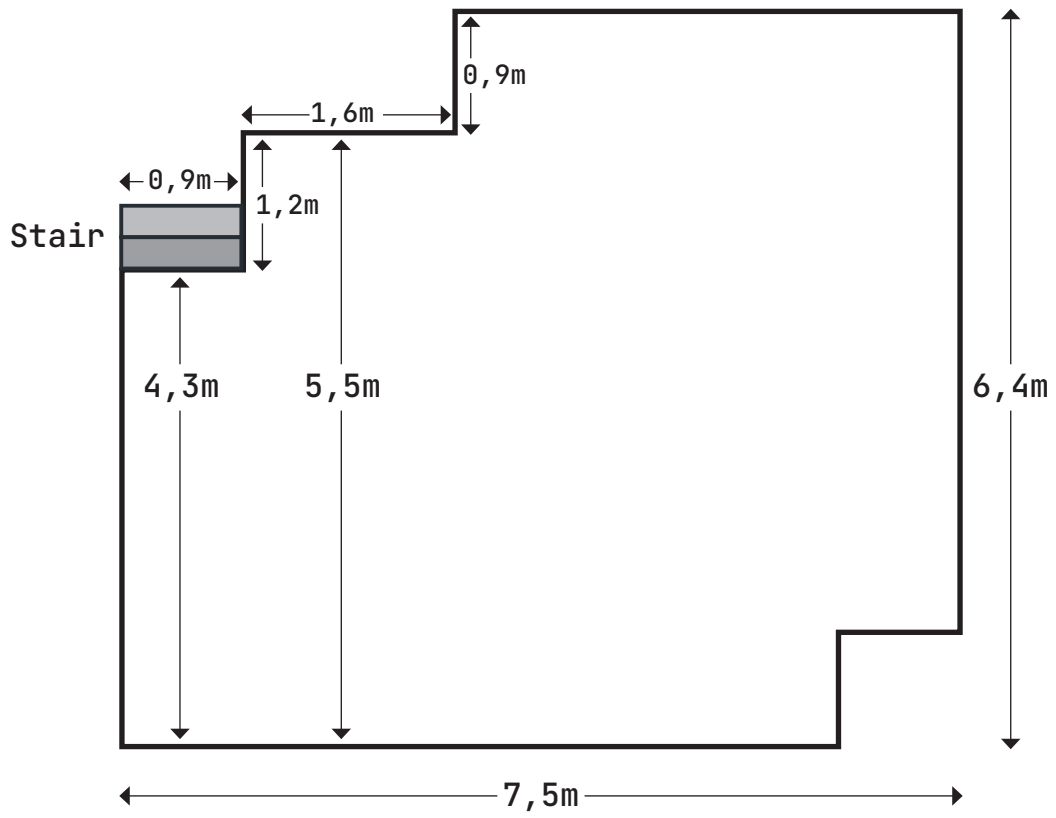

## Stage to ceiling

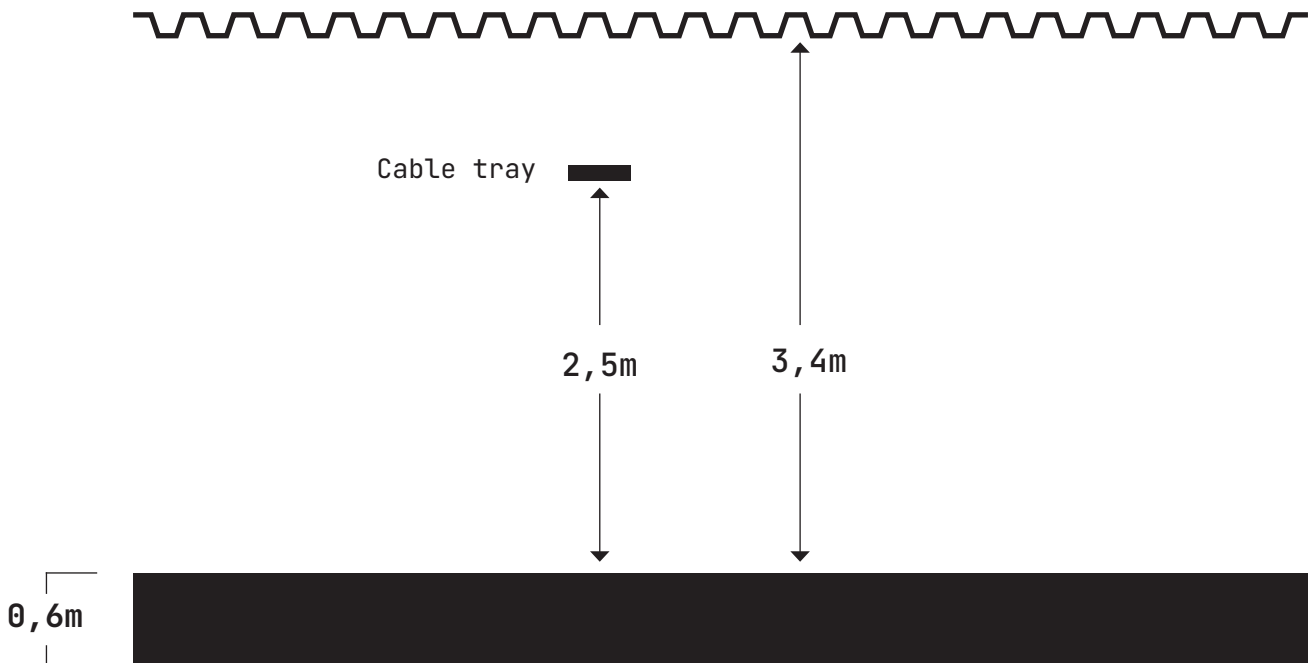

# MAIN STAGE FLOOR

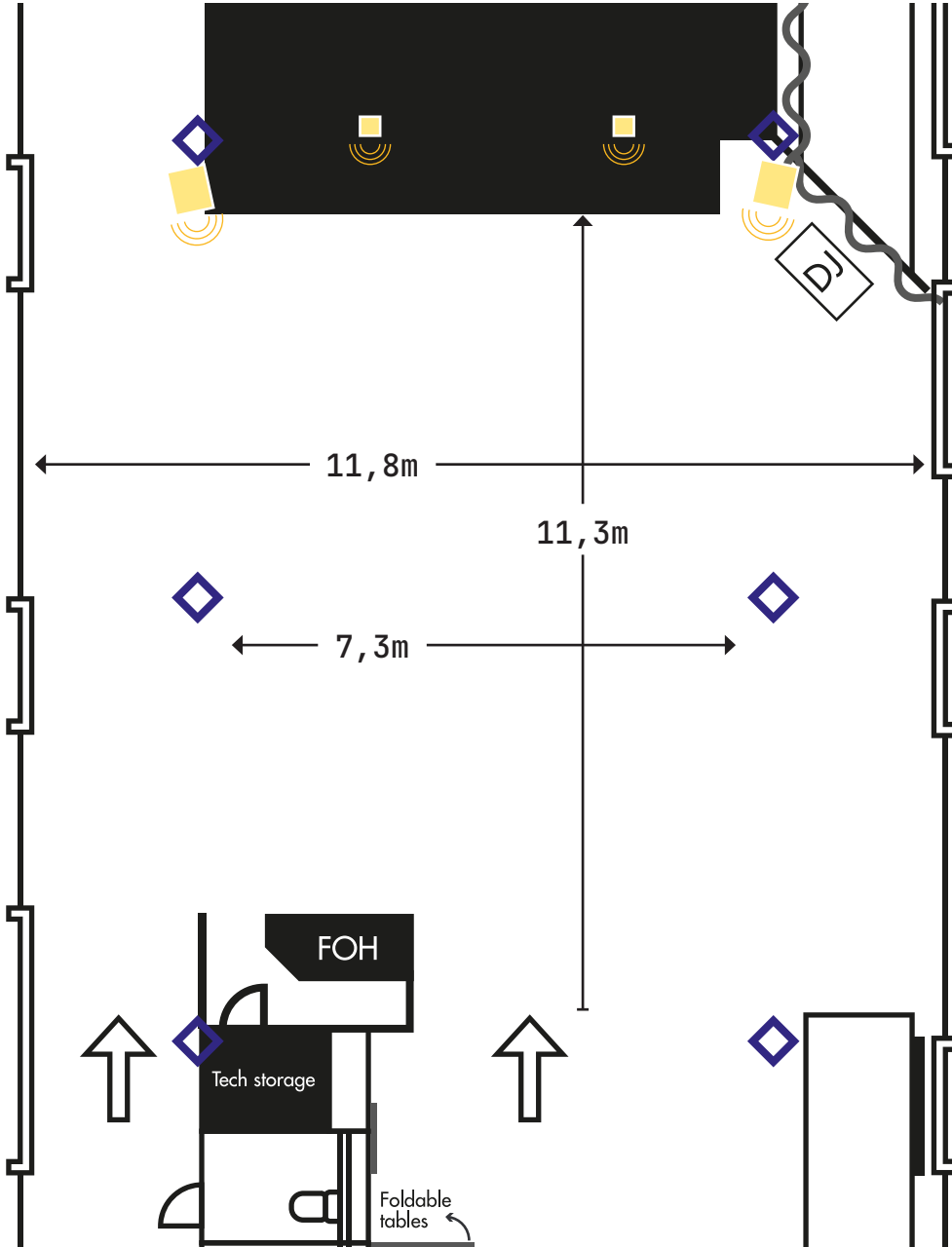

# VENUE TERRACE

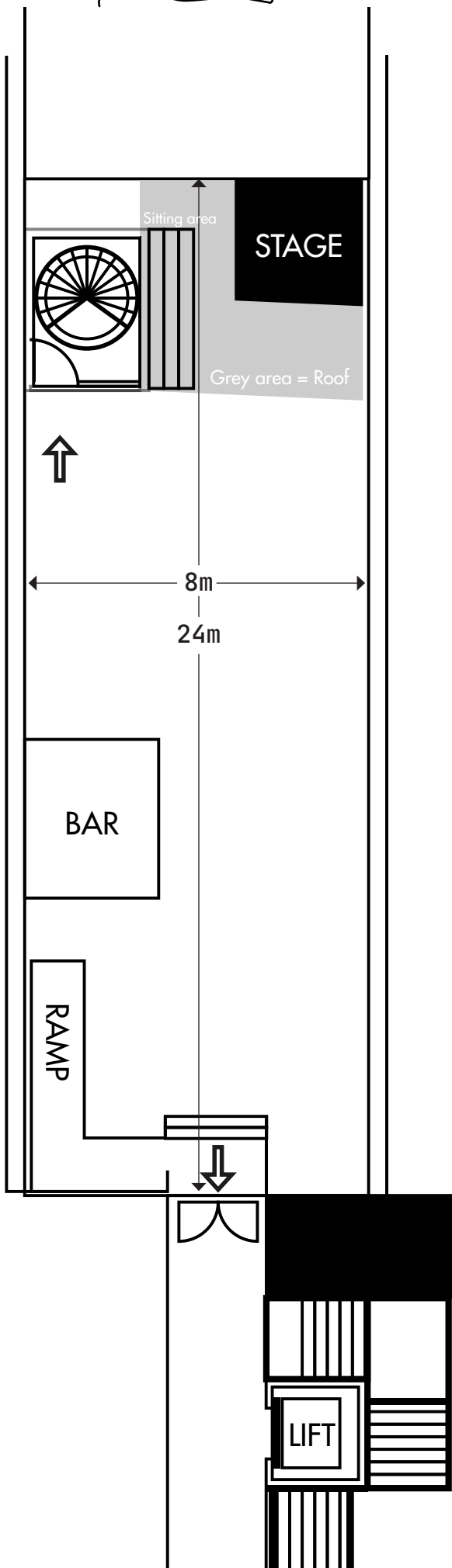

# TERRACE STAGE DIMENSIONS



Grey area = roof

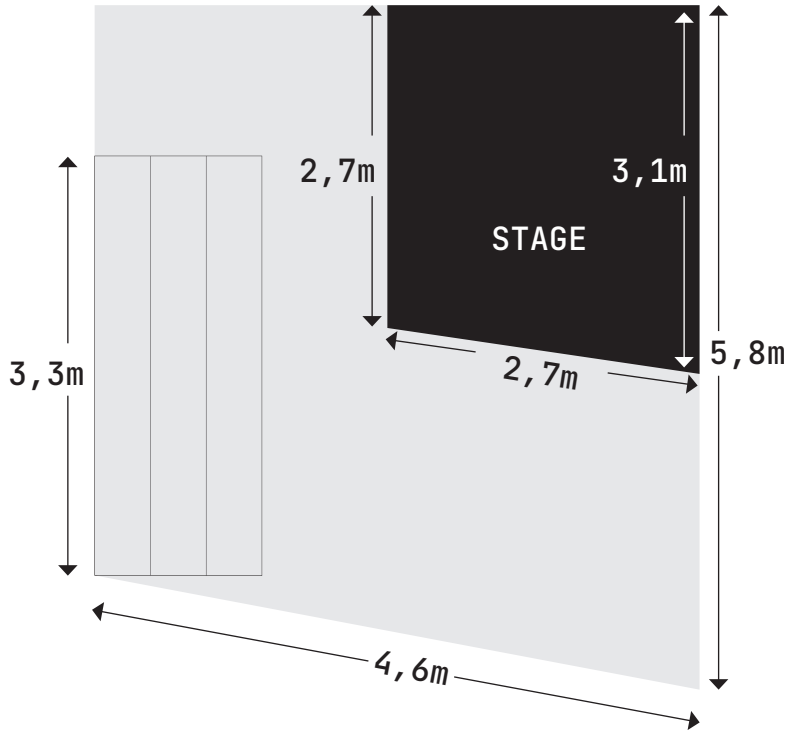

Stage to roof

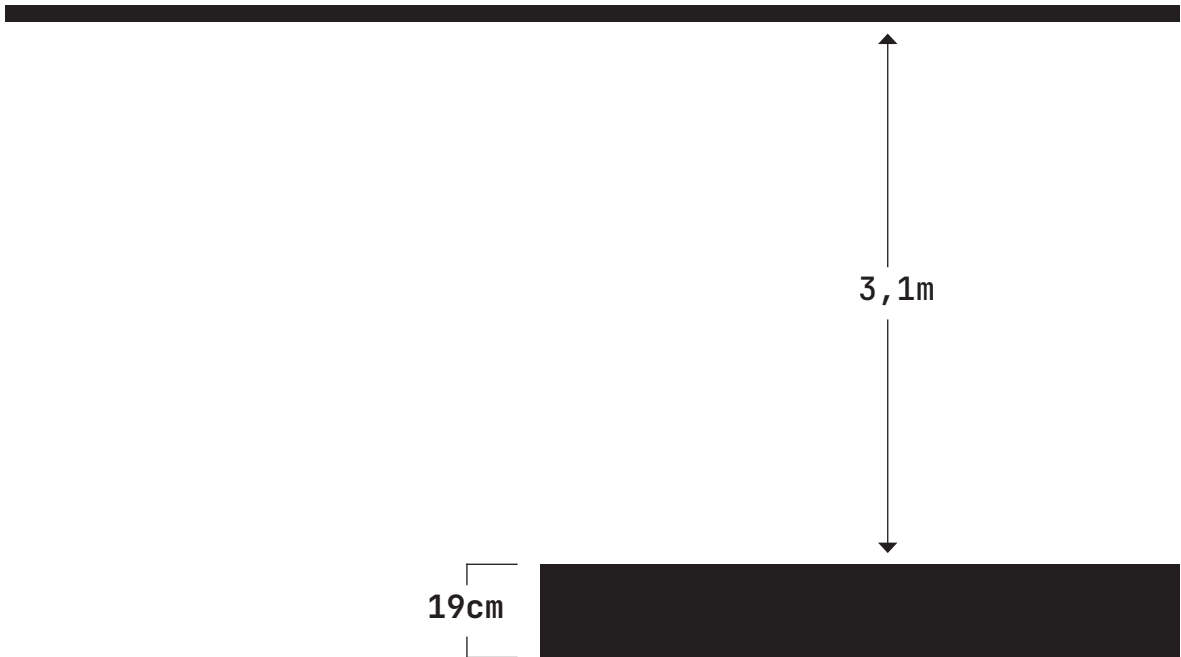



# MAIN STAGE



# BAR STAGE



# TERRACE STAGE

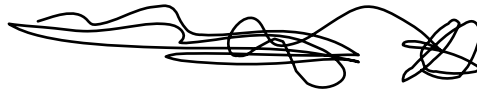

## DRESSING ROOM



*Our dressing room is not available for performances on the terrace.*

Includes:  
Shower  
2 Toilets  
Pentry  
Fridge

Can be divided in to two separated dressing rooms.



## GREEN ROOM / BACKSTAGE



## PA MAIN STAGE

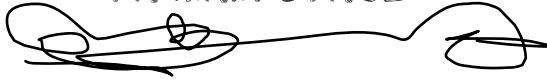

### PA

Dot Audio Line Aray  
2 x Dot Audio "Bull" Tops  
2 x Dot Audio "Bull" Mids

Active 2-way coaxial enclosure  
Usable bandwidth (-6dB) 100Hz - 20kHz  
Nominal dispersion angle (hvx) 90° x 10°  
Transducers LF: 4x8" neodymium  
HF: 4x4" neodymium planar wave driver  
Nominal impedance (-6 dB) 141 dB 1 enclosure  
Maximum SPL (-6 dB) 126 dB 1 enclosure  
RMS handling capacity (RMS/peak 10ms)  
LF: 800/2400W  
HF: 320/1800W  
Dimensions (WxHxD) 550x490x550mm  
Weight (net) 34 Kg  
Connectors 2 x Neutrik NL4  
Material Baltic birch plywood  
Finish Black Polyurethane coating

### 6 x Dot Audio Bass Reflex "550 Subs"

Bass reflex with LTAP vent  
Dispersion Omni or cardioid depending on preset  
Usable bandwidth (-6dB) 35Hz - 300Hz  
Transducers LF: 1 x 18" with 4" voice coil  
Nominal impedance 8 Ω (+1/-1)  
Maximum SPL (-6dB) 137dB  
RMS handling capacity RMS/peak 10 ms LF: 1200/4800W  
Dimensions (WxHxD) 730 x 550 x 550 mm  
Weight (net) 48 Kg  
Connectors 3xNeutrik NL4 (2 linked, 1 twisted 2+>1+/2- >1-)  
Material Baltic birch plywood  
Finish Black Polyurethane coating  
Rigging Dual integrated pole mount socket M20

### 2 x Dot Audio Front Fill "Vkyr 5"

#### Amplifier stage

1 x Dot Audio 8:1, fixed and locked  
1 x Dot Audio 4:5, fixed and locked

Eight channels of sonically pure Class D amplification  
Unique, precise, 96kHz digital signal processing  
85V to 240V Auto-sensing PSU  
3,000 to 10,000 watts RMS total output  
Analogue, AES3 and optional Dante TM digital network audio

Four channels of sonically pure Class D amplification  
Unique, precise, 96kHz digital signal processing  
85V to 240V Auto-sensing PSU  
20,000 watts RMS total output  
Analogue, AES3 and optional Dante TM digital network audio

### Main Stage Wedge

8 x Passive 12" - Dot Audio

### Wedge amplifier

2 x LAB GRUPPEN 1200C  
On wheels, locked

## PA BAR STAGE



### PA

Dot Audio Tops  
4 x "Vkyr 5"

Dot Audio Monitor  
2 x "iDE 8"

Active 2-way coaxial enclosure  
Usable bandwidth (-6dB) 55Hz - 20kHz  
Nominal dispersion angle (hvx) 60° conical  
Transducers LF:1x8"  
HF: 1x1,73"  
Nominal impedance 8 Ω (+1/-1)  
Maximum SPL (-6 dB) 132 dB  
RMS handling capacity (RMS/peak 10ms)  
250/1000W  
Dimensions (WxHxD) 440x515x475mm  
Weight (net) 16 Kg  
Connectors 2 x Neutrik NL4  
Material Baltic birch plywood  
Finish Black Polyurethane coating

Dot Audio Bass Reflex  
2 x "Mungo 15"

Bass reflex, dual LTAP vents  
Dispersion Omni or cardioid depending on preset  
Usable bandwidth (-10dB) 27Hz - 200Hz  
Transducer 1 x 15" 3" coil  
Nominal impedance 8 Ω (+1/-1)  
Maximum SPL (-6 dB) 130 dB  
RMS handling capacity (RMS/peak 10ms) 1500/6000W  
Dimensions (WxHxD) 550x380x760mm  
Weight (net) 31 Kg  
Connectors 3xNeutrik NL4 (2 linked, 1 twisted 2+ > 1+ / 2- > 1-)  
Material Baltic birch plywood  
Finish Black Polyurethane coating  
Rigging Integrated pole mount socket M20

### Amplifier Bar

1 x Dot Audio 8:1, fixed and locked

## PA TERRACE



### PA

Dot Audio Tops  
8 x 6,5" (Special build)

### Cardio SUB

1 x Dot Audio 4x15" (Special build)

### Amplifier Terrace

1 x Linea Amp 4x1250 watt DSP

# SOUND MAIN STAGE



## **FOH Live Console**

### **1 x Allen & Heath SQ6**

48 input channels, 36 bus digital mixer  
96 kHz FPGA processing  
25 Faders / 6 Layers  
24 Mic/line  
12 Stereo mixes

## **Portable Digital Mixer**

### **1 x Mackie DL16S**

16 Channels  
8 XLR Outputs  
Wireless mixing via app

## **Stagebox/multi**

### **2 x A&H DX168**

16 XLR Input / 8 XLR Output 96kHz Portable DX Expander  
(one on each side of stage = 32 Inputs and 16 Outputs)

8 x Radial pro48 DI  
2 x Radial D2 stereo DI  
4 x Passive DI

1 x Snake (Klotz StraightLink AES/EBU 81channels- 8/0 XLR)

## **Microphones**

3 x Shure SM58SE Cardioid Dynamic  
6 x Shure SM58-LCE Microphone Cardioid Dynamic  
6 x Shure Beta58  
1 x Shure Beta52  
1 x Shure Beta91 A  
4 x Shure SM57 Microphone Dynamic  
4 x Sennheiser e904  
2 x Sennheiser e906  
4 x Lewitt ltc040  
2 x Audio Technica ae3000  
1 x Shure 7PC DRUMKIT

## **Stands**

12 x K&M 210/9 Microphone stand, long boom  
6 x K&M 260 Microphone stand, black, round foot  
2 x K&M Small mic boom stand, telescopic bar  
2 x K&M Small mic boom stand  
1 x Keyboard stand  
2 x Guitar stand

## SOUND TERRACE

3 x SM57 Microphone Dynamic  
3 x SM582  
4 x DI boxar  
1 x PG Drum mic kit

## DJ EQUIPMENT

1 x Pioneer DJM A9  
2 x Pioneer DJM 900 Nexus  
2 x Pioneer CDJ 3000  
2 x Pioneer CDJ 2000 Nexus  
2 x Pioneer CDJ 900 Nexus  
2 x Technics 1200

## LIGHT & FX

### FOH Stand alone DMX controller

1 x Wolfmix W1  
Up to 4 DMX universes  
(2048 channels, add-on required for U3+4)

1 x Stairville DDC-12 DMX Controller  
Connected to Wolfmix

### Front light

☐ 5 x Fresnel Minuette  
☑ 1 x Fresnel led  
☑ 2 x Led wash: RGB-W+UV

### Stage light

☑ 8 x Led wash  
RGB-W+UV: 3 SR, 3 SL, 2 upstage  
☑ 3 x Led wash on floor upstage

☑ 2 x Blinders

☑ 4 x Moving Head big eye 19  
Set to sound to light mode

### FX

1 x Hazer Look Unique 2.1

### A/V

1 x Short throw projector



# LIGHT MAIN STAGE

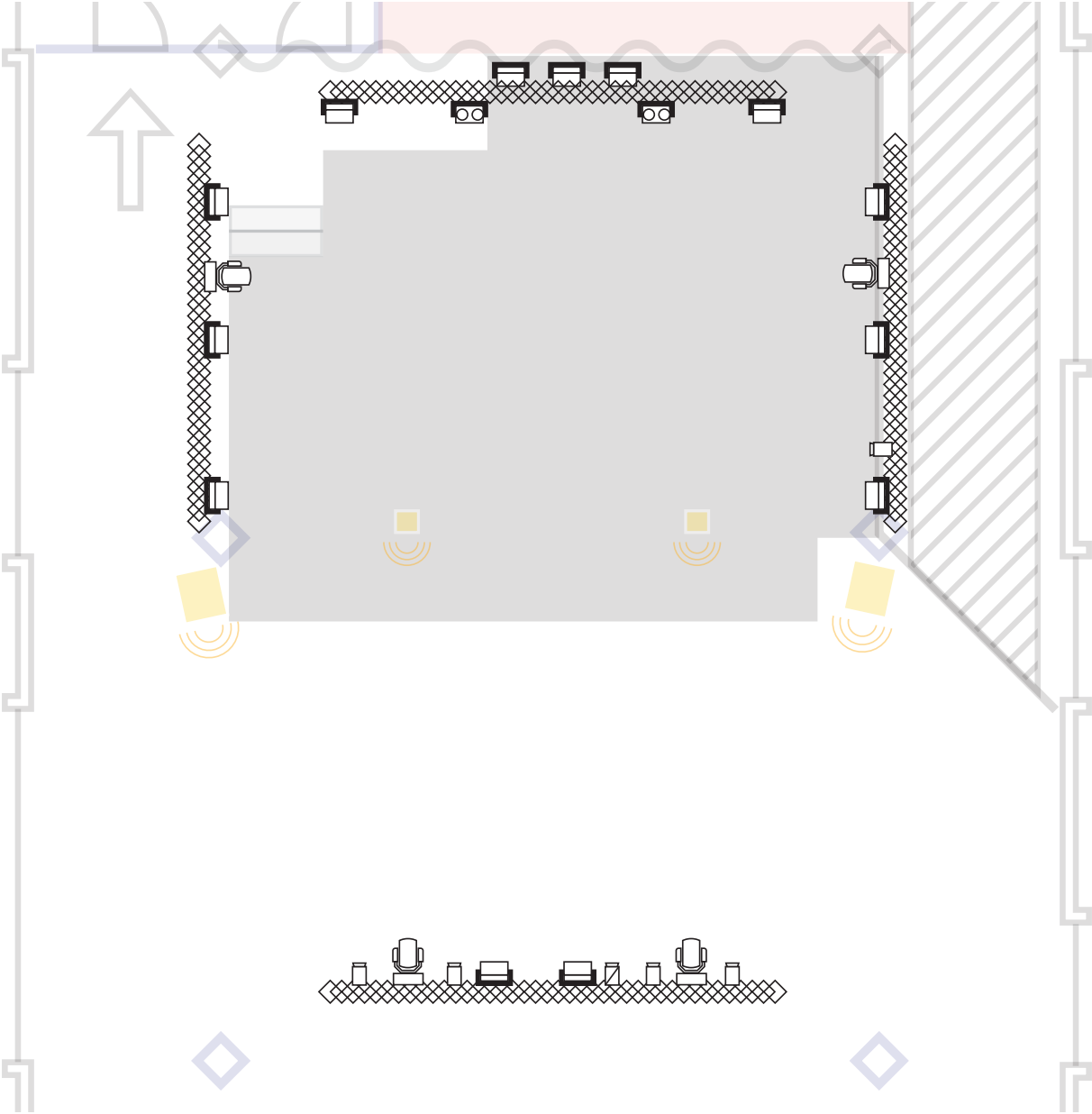



**KOLLEKTIVET**  
**LIVET**

[www.kollektivetlivet.se](http://www.kollektivetlivet.se)